

Tel-Tail®

LOGO LIGHT KIT

ILLUSTRATED PARTS CATALOG and SERVICE INSTRUCTIONS

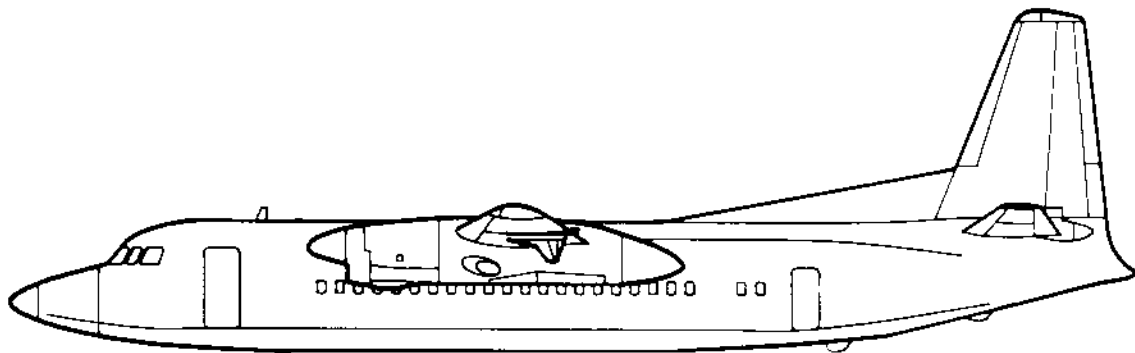

MODEL - FOKKER 50

SERIES - ALL

PART NO.- 02733125



DEVORE AVIATION CORPORATION
ALBUQUERQUE NEW MEXICO USA OF AMERICA

6104B JEFFERSON BLVD. N.E.
ALBUQUERQUE, NEW MEXICO
(505) 345-8713
FAX (505) 344-3835

A system of indentation under the description column is used to simplify your requirements. When a major assembly is required for replacement, all components within the respective assemblies will be provided. If an individual part within an assembly is required, you can order the part and quantity needed separately. An example and explanation is as follows.

| FIG 1.0 TEL-TAIL LIGHT KIT | | | |
|----------------------------|-------------|---------------------------|---------------|
| FIGURE | PART NUMBER | DESCRIPTION | QTY. PER ASSY |
| | 02733125-1 | Fokker 50 Flood Light Kit | 1 |
| 1 | 02733017-1 | Window Assembly | 1 |
| 2 | MS24694-S5 | Screw | 10 |
| 3 | 02733029-5 | Lamphousing Assembly | 1 |
| 4 | 02733029-3 | Support Assembly | 1 |

When ordering the 02733029-5 Lamphousing Assembly, you will receive all components intended under that assembly. You need not order any sub-assembly components of that assembly. If, however, you require only the replacement for the 02733029-3 Support Assy. you receive only the Support assy. as an individual item.

NOTE: When ordering replacement items or assemblies, be sure that the mounting hardware for installation is ordered as well. For example if you order the Window Assembly you will also require the ten MS244694-S5 screws to mount it to the aircraft. (see FIG 1.0 page 4)



FIG. 1.0 FOKKER 50 FLOOD LIGHT KIT

| FIGURE | PART NUMBER | DESCRIPTION | QTY. PER ASSY |
|-------------|--------------|-------------------------------------|---------------------|
| - | 02733125-1 | Fokker 50 Tail Flood Light Kit (LH) | - |
| 1 | 02733017-1 | Window Assembly | 1 |
| 2 | MS24694-S5 | Screw | 10 |
| 3 | 02733029-5 | Lamphousing Assembly | 1 |
| 4 | 02733029-3 | Support Assembly | 1 |
| 5 | 00933009-41 | Fokker 50 Shell Assembly | 1 |
| 6 | 00933039-1 | Housing Shell | 1 |
| 7 | 00003073-11 | Retaining Ring | 1 |
| 8 | 00033085-3 | Washer | 3 |
| 9 | 00033108-11 | Gasket | 1 |
| 10 | 72733018-1 | Grommet | 1 |
| 11 | NAS1635-3-8 | Screw | 3 |
| 12 | MS35489-134X | Grommet | 4 |
| 13 | AN3-5A | Bolt | 4 |
| 14 | 00003041-13 | Washer | 4 |
| 15 | 02733127-1 | Angle Assembly | 1 |
| 16 | NAS1303-3 | Bolt | 3 |
| 17 | AN960-KD10L | Washer | 3 |
| 18 | 02733128-1 | Angle Assembly | 1 |
| 16 | NAS1303-3 | Bolt | 3 |
| 17 | AN960-KD10L | Washer | 3 |
| 19 | 02733129-1 | Channel Assembly | 1 |
| 20 | AN3-4A | Bolt | 2 |
| 21 | AN3-3A | Bolt | 2 |
| 17 | AN960-KD10L | Washer | 4 |
| 22 | 02733130-2 | Shock Mount Bracket Assembly | 1 |
| 21 | AN3-3A | Bolt | 2 |
| 17 | AN960-KD10L | Washer | 2 |
| 23 | 02733130-1 | Shock Mount Bracket Assembly | 1 |
| 21 | AN3-3A | Bolt | 2 |
| 17 | AN960-KD10L | Washer | 2 |
| 24 | L44-AA-1/2 | Shock Absorber | 4 |
| 25 | MS27039-0808 | Screw | 12 |
| 26 | MS27039-0809 | Screw | 4 |
| 27 | AN960-KD8L | Washer | 16 |
| 28 | 02733131-1 | Lamp Mount Bracket Assembly | 1 |
| 29 | MS27039-0807 | Screw | 2 |
| 30 | MS35333-38 | Lockwasher | 2 |
| 31 | 02733132-1 | Lamp Mount Bracket Assembly | 1 |
| 29 | MS27039-0807 | Screw | 2 |
| 30 | MS35333-38 | Lockwasher | 2 |
| 32 | 00033038 | Lamp (28V, 150W) | 1 |
| Fkr50-2.dwg | | | |



FIG. 1.0 FOKKER 50 FLOOD LIGHT KIT

| FIGURE | PART NUMBER | DESCRIPTION | QTY. PER ASSY |
|--------|--------------|-------------------------------------|---------------|
| - | 02733125-2 | Fokker 50 Tail Flood Light Kit (RH) | - |
| 1 | 02733017-2 | Window Assembly | 1 |
| 2 | MS24694-S5 | Screw | 10 |
| 3 | 02733029-5 | Lamphousing Assembly | 1 |
| 4 | 02733029-3 | Support Assembly | 1 |
| 5 | 00933009-41 | Fokker 50 Shell Assembly | 1 |
| 6 | 00933039-1 | Housing Shell | 1 |
| 7 | 00003073-11 | Retaining Ring | 1 |
| 8 | 00033085-3 | Washer | 3 |
| 9 | 00033108-11 | Gasket | 1 |
| 10 | 72733018-1 | Grommet | 1 |
| 11 | NAS1635-3-8 | Screw | 3 |
| 12 | MS35489-134X | Grommet | 4 |
| 13 | AN3-5A | Bolt | 4 |
| 14 | 00003041-13 | Washer | 4 |
| 15 | 02733127-1 | Angle Assembly | 1 |
| 16 | NAS1303-3 | Bolt | 3 |
| 17 | AN960-KD10L | Washer | 3 |
| 18 | 02733128-1 | Angle Assembly | 1 |
| 16 | NAS1303-3 | Bolt | 3 |
| 17 | AN960-KD10L | Washer | 3 |
| 19 | 02733129-2 | Channel Assembly | 1 |
| 20 | AN3-4A | Bolt | 2 |
| 21 | AN3-3A | Bolt | 2 |
| 17 | AN960-KD10L | Washer | 4 |
| 22 | 02733130-1 | Shock Mount Bracket Assembly | 1 |
| 21 | AN3-3A | Bolt | 2 |
| 17 | AN960-KD10L | Washer | 2 |
| 23 | 02733130-2 | Shock Mount Bracket Assembly | 1 |
| 21 | AN3-3A | Bolt | 2 |
| 17 | AN960-KD10L | Washer | 2 |
| 24 | L44-AA-1/2 | Shock Absorber | 4 |
| 25 | MS27039-0808 | Screw | 12 |
| 26 | MS27039-0809 | Screw | 4 |
| 27 | AN960-KD8L | Washer | 16 |
| 28 | 02733131-2 | Lamp Mount Bracket Assembly | 1 |
| 29 | MS27039-0807 | Screw | 2 |
| 30 | MS35333-38 | Lockwasher | 2 |
| 31 | 02733132-2 | Lamp Mount Bracket Assembly | 1 |
| 29 | MS27039-0807 | Screw | 2 |
| 30 | MS35333-38 | Lockwasher | 2 |
| 32 | 00033038 | Lamp (28V, 150W) | 1 |

Fkr50-1.dwg



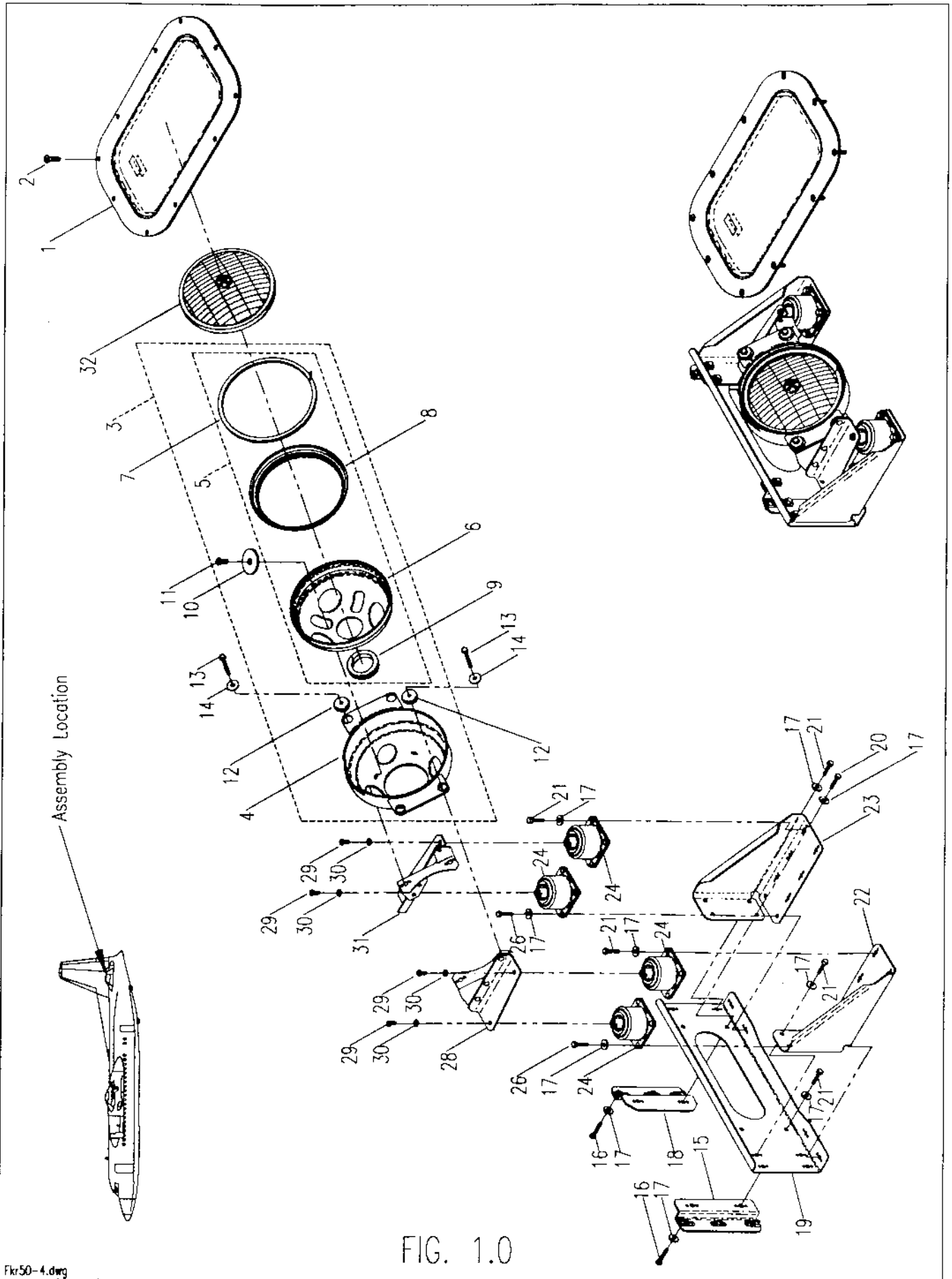

FIG. 1.0

Fkr50-4.dwg

LAMP ADJUSTMENT PROCEDURES

Adjustment should be performed at night or in a darkened hangar.

1. Remove the window assembly from the horizontal stabilizer. Remove the lamp retaining ring and the lamp from the inner shell.
2. Loosen the three adjustment screws to allow a snug movement of the shell housing.
3. Nest the lamp firmly in the moveable shell housing and hold it in place by hand. Align the filament of the lamp approximately along the rudder hinge line. Turn on the light and adjust the shell housing until the light beam produces the desired illumination of the tail. Mark the lamp index lug position on the shell housing. Turn the light off and remove the lamp only. Without moving the shell housing, tighten the three screws securing the shell housings to the support housing. NOTE: This setting is not disturbed when you replace lamps.
4. Position the lamp in the adjusted shell to nest firmly on the gasket. Install the lamp retaining ring, securing the lamp into the housing assembly. Reinstall the window assembly.

LAMP REPLACEMENT PROCEDURES

1. Remove the window assembly. Remove the lamp retaining ring and lamp from the inner shell. Disconnect wiring from the lamp.
2. Connect wires to the lamp and securely tighten the screws. Lightly coat the lamp-side surface of the gasket with high temperature anti-seize compound G.E. G-661 or an equivalent.
3. Replace the lamp in the original lug/housing index position and secure it with the retaining ring. Reinstall the window assembly.

NOTE: At each lamp change check the four shock absorbers (item 24 page 4) for damage. Replace them if required.

GASKET REPLACEMENT

1. Remove the window assembly. Remove the lamp retaining ring and the lamp from the inner shell. Remove the old gasket and install the new gasket in the housing shell. Lightly coat the lamp-side surface of the gasket with high temperature anti-seize compound G.E. G-661 or an equivalent.
2. Replace the lamp in the original lug/housing index and secure with the retaining ring. Reinstall the window assembly.

