



**TAIL ROTOR FLOODLIGHT KIT
ILLUSTRATED PARTS CATALOG
and
SERVICE INSTRUCTIONS**

HELICOPTERS

SINGLE LAMP ASSEMBLY

No. 00033096-5,-7,-8,-11,-13

DE VORE AVIATION CORPORATION



6104B KIRCHER BLVD. N.E.
ALBUQUERQUE, NEW MEXICO 87109
(505) 345-8713
TELEX 660-436

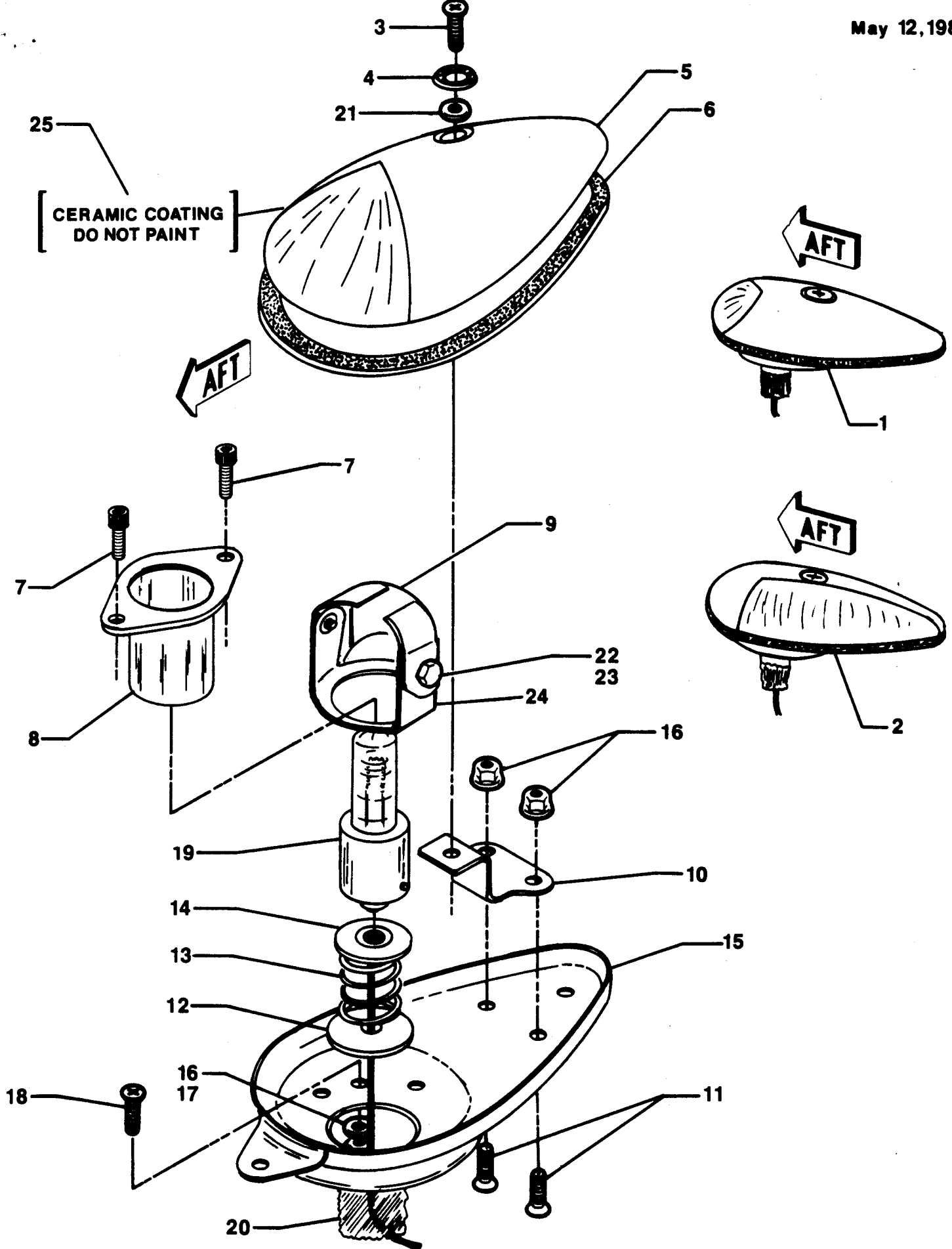

HELICOPTER TAIL ROTOR FLOODLIGHT

ITEM NO.	PART NUMBER	DESCRIPTION	QUANTITY
1	00033096-5-11-13	Light Assy	
2	00033096-7(LH)-8(RH)	Light Assy	
3	MS24693-C30	Screw	1
4	NAS391B4P	Washer	1
5	00003027 (See Notes)	Cover Glass	1
6	00003006-1 (or-3)	Gasket	1
7	MS24677-1	Screw	2
8	00003001-1	Lampholder Assy	1
9	00003004-1	Reflector	1
10	00003024-1	Support Assy.	1
11	MS24693S-26	Screw	2
12	00003007-1	Washer	1
13	00003020-1	Spring	1
14	00003028-1	Contact Assy.	1
15	00003030 (See Notes)	Base Assy.	1
16	MS21042L06	Nut	3
17	AN960PD6	Washer	1
18	MS24693-C28	Screw	1
19	DA-27	Lamp	1
20	RT876	Shrink Tubing	1
21	AS-106	"O" Ring	1
22	TF538C6-4	Cap Screw	2
23	MS35335-86	Lockwasher	2
24	00003026-1	Yoke Assy.	1
25	00033031-9	Decal	1

NOTES:

00033096-5 Light Assy. Consists of 00003030-3 Base Assy. and 00003027-9 Cover Glass

00033096-11 Light Assy. Consists of 00003030-5 Base Assy. and 00003027-9 Cover Glass

00033096-13 Light Assy. Consists of 00003030-3 Base Assy. and 00003027-11 Cover Glass

00033096-7 (L.H.), -8 (R.H.) Light Assy. Consists of 00003030-1 Base Assy. and 00003027-5 (L.H.), -6 (R.H.) Cover Glass

DE VORE AVIATION CORPORATION



PRECAUTIONS

1. When operating lamp with cover glass removed, wear safety glasses or equivalent eye protection. Do not look directly at lamp filament.
2. Lamp and reflector become extremely hot – use extreme care while making adjustments.
3. Handling lamp with bare fingers will deposit fingerprints and skin oil on lamp. Remove, before illumination, by cleaning with a grease free solvent such as acetone. Use special rubber tool included in kit to remove or replace lamp.

ADJUSTMENT PROCEDURE:

1. Before applying power:
2. Remove cover glass.

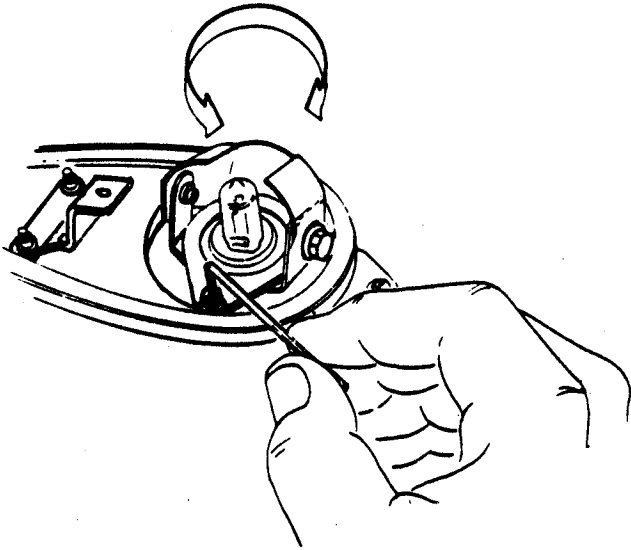

3. Loosen the two (2) capscrews at the lampholder of each lamp (bottom of assembly base) to allow the reflector to be rotated around the lamp.

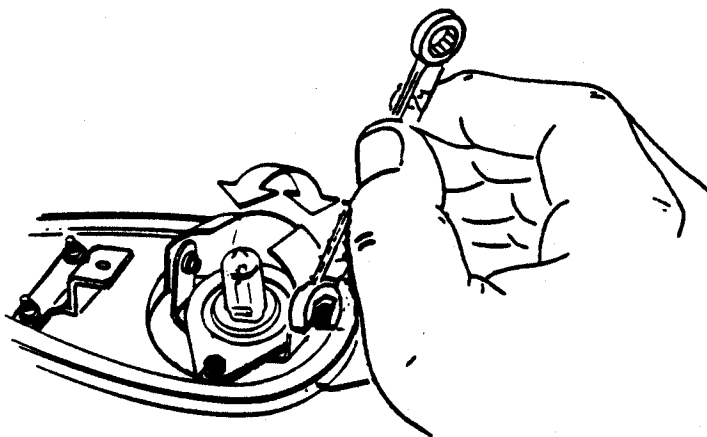

4. Loosen the two (2) 1/4 hex head screws (on either side of lamp) in the reflector/yoke assembly, to allow the reflector to be tilted.

5. Aim reflector at the tail surface.
6. Turn on aircraft DC power and actuate "Tel-Tail" Recognition light switch.
7. Observe the light pattern and reposition reflector if necessary.
8. Set the cover glass on the fixture, do not install attaching screw at this time.
9. Observe that the cover glass changes the light pattern to eliminate bright and dark spots.
10. Reposition reflector if required to provide even coverage.

NOTE: It is much easier to adjust the reflector if the lamp is turned off while the adjustment is being made.

11. When the adjustment is complete, turn off electrical power and securely tighten adjustment screws. Recheck to be sure adjustment was not changed when screws were tightened.
12. Install cover glass.
13. Repeat the adjustment procedure for the fixture on the other side of the airplane.

Lamp Replacement:

- 1., Remove cover glass.
- 2., Use special rubber tool supplied in kit.

